









LONGCROFT WIND FARM

FIGURE 3.5

INDICATIVE SITE ENTRANCE LAYOUT

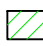
© CROWN COPYRIGHT, ALL RIGHTS RESERVED.
2023 LICENCE NUMBER 0100031673.

KEY:

-  EXISTING ROAD/TRACK SURFACE
-  UPGRADED SITE ACCESS TRACK
-  EXISTING SURFACE TO BE REMOVED, TOPSOILED AND RESEEDED.
- 
 - 60mm SURFACE COURSE, 75mm BINDER COURSE
 - MINIMUM 150mm TYPE 1 SUB-BASE SOFT AREAS AND UNSUITABLE MATERIAL (PEAT, TOPSOIL, SILT) TO BE REMOVED.
 - MINIMUM FALL FROM ENTRANCE GATE TO PUBLIC ROAD 1:100.
 - EXISTENCE OF SERVICES TO BE CHECKED WITH RELEVANT AUTHORITIES.
-  PROPOSED TEMPORARY STOCK PROOF FENCE
-  PROPOSED GATE

NOTES:

1. DO NOT SCALE FROM DRAWING.
2. DETAILS AND DIMENSIONS ARE INDICATIVE ONLY AND SUBJECT TO CHANGES AT DETAILED DESIGN STAGE.
3. APPROPRIATE SUDS DESIGN MEASURES WILL BE EMPLOYED AT DETAIL DESIGN STAGE.

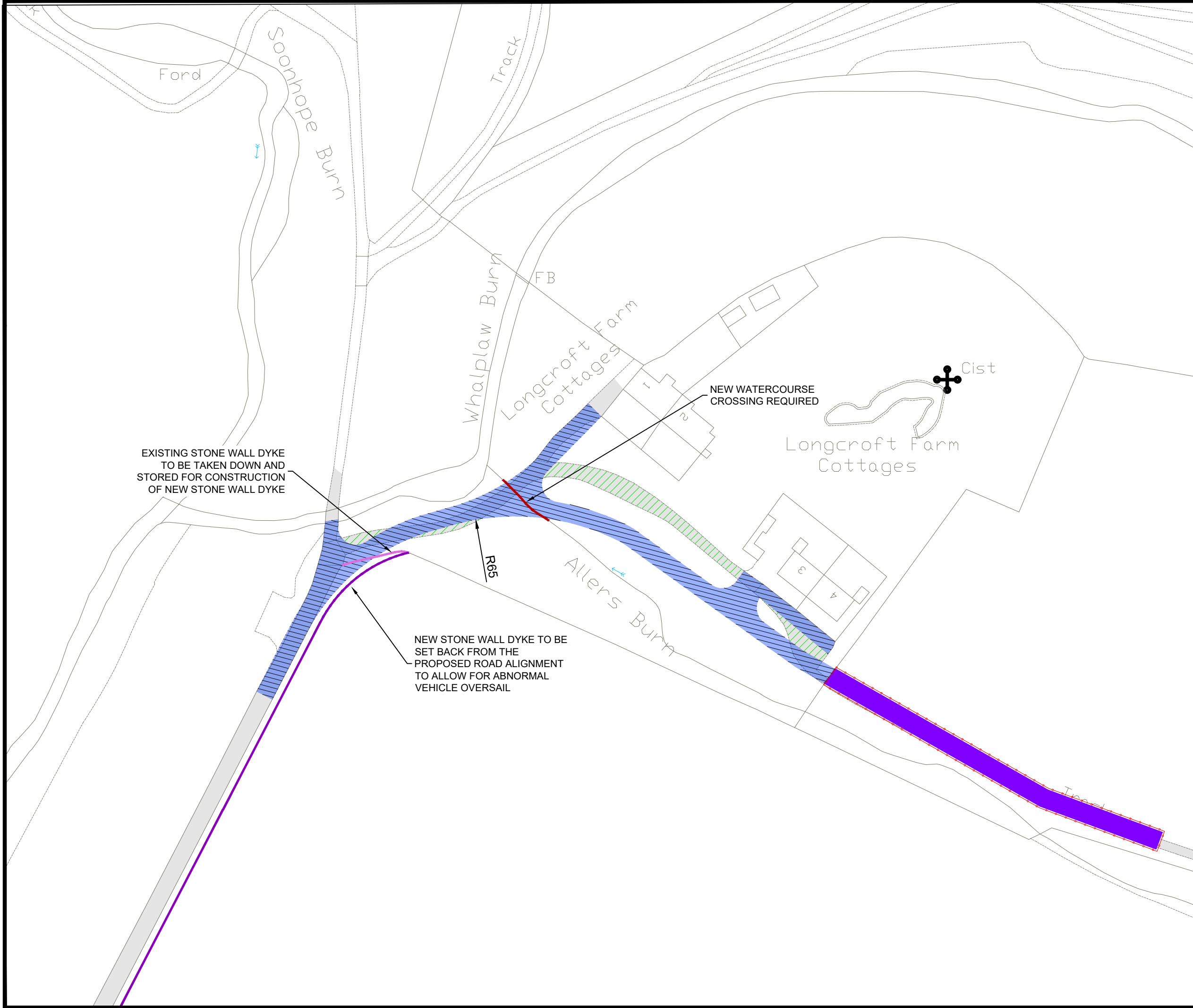
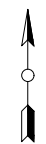

LAYOUT DWG	N/A	T-LAYOUT NO.	N/A
------------	-----	--------------	-----

DRAWING NUMBER	04728-RES-ACC-DR-PE-003	REV	1
----------------	-------------------------	-----	---

SCALE - 1:1000 @ A3

ENVIRONMENTAL IMPACT ASSESSMENT REPORT 2023

THIS DRAWING IS THE PROPERTY OF RENEWABLE ENERGY SYSTEMS LTD. AND NO REPRODUCTION MAY BE MADE IN WHOLE OR IN PART WITHOUT PERMISSION