

**LONGCROFT
WIND FARM**

FIGURE 3.8d

**TYPICAL DRAINAGE
DETAILS**

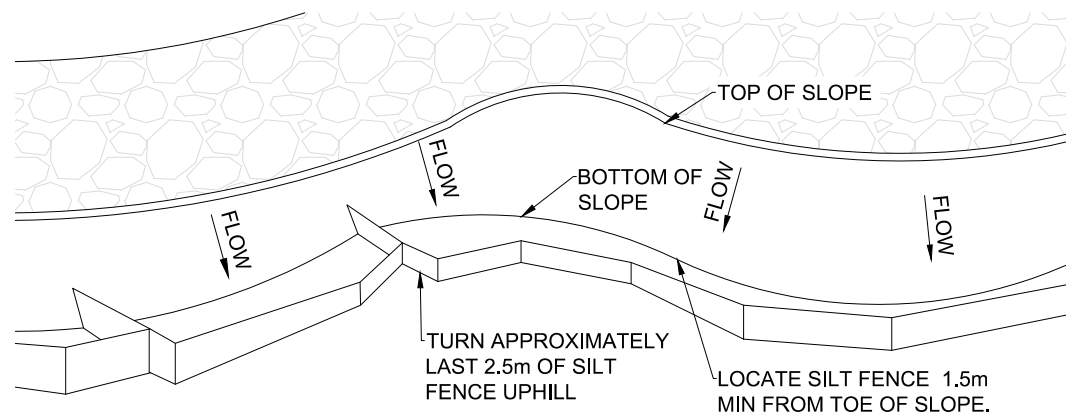

TYPICAL SILT FENCE BOTTOM OF SLOPE
SCALE - NTS

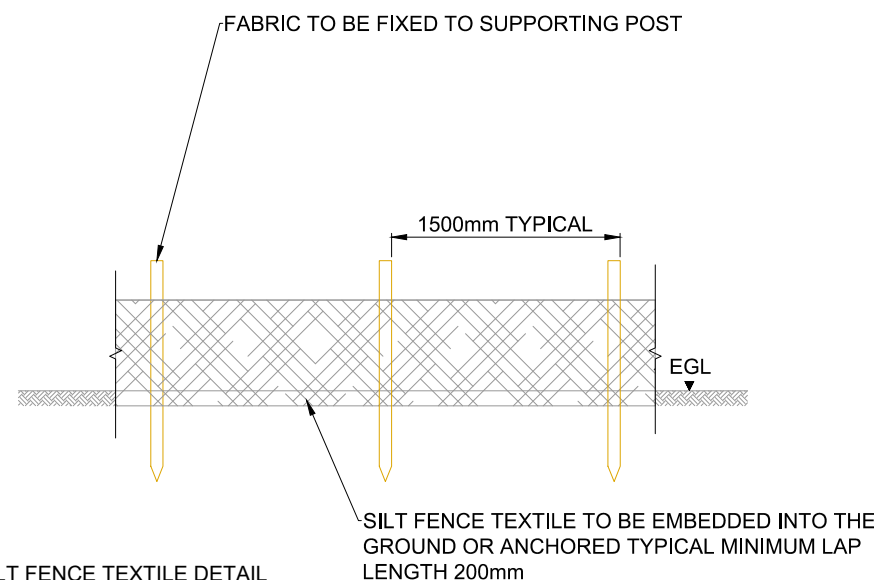

SILT FENCE TEXTILE DETAIL
SCALE 1:20

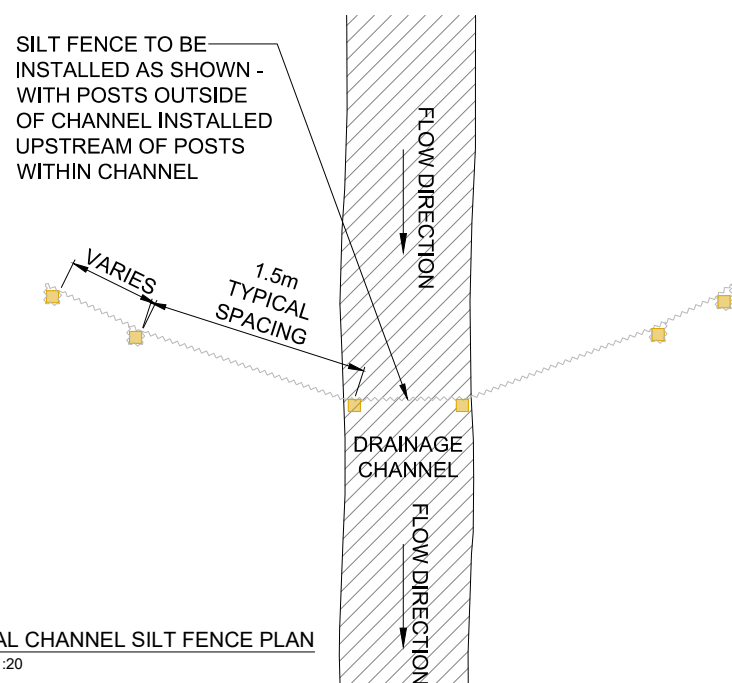

TYPICAL CHANNEL SILT FENCE PLAN
SCALE - 1:20

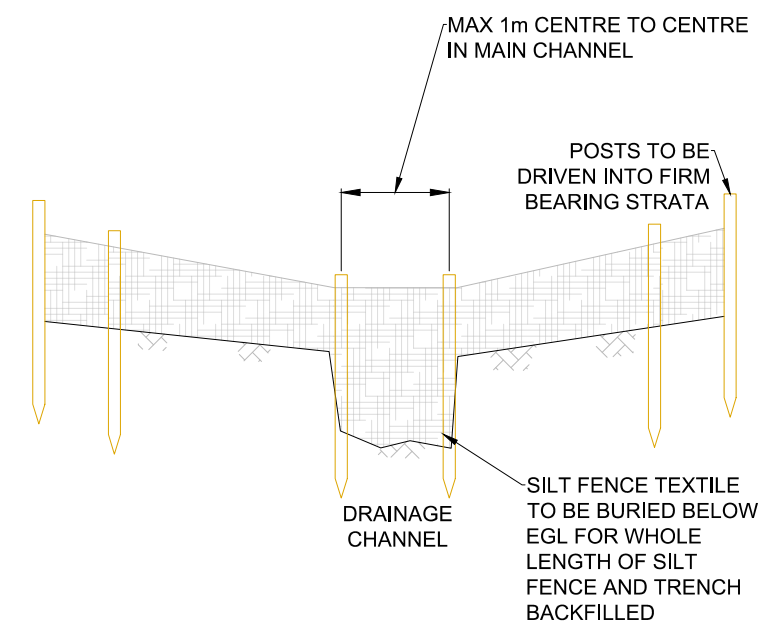

TYPICAL CHANNEL SILT FENCE ELEVATION
SCALE - 1:20

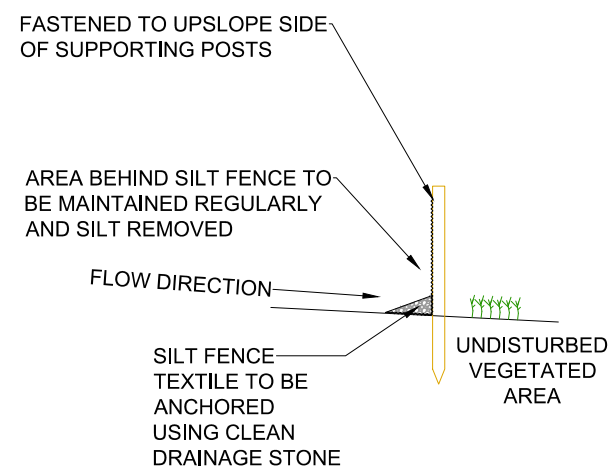

ANCHORED TYPE OPTION
SCALE 1:20

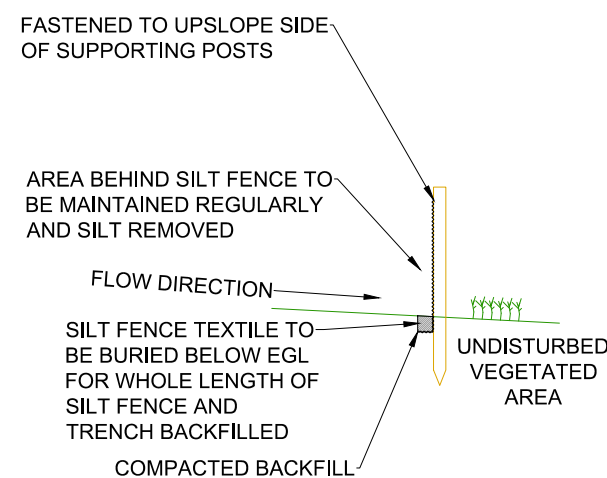

BURIED TYPE OPTION
SCALE 1:20

NOTES:

1. SUDS SYSTEM TO BE CONSTRUCTED PRIOR TO, OR AT THE SAME TIME AS THE ACCESS TRACK & HARDSTANDS. INTERIM MEASURES SUCH AS THE PLACEMENT OF SILT FENCES TO BE USED AROUND WATERCOURSES AND RETAINED IN PLACE UNTIL SUDS ARE ESTABLISHED AND PROVIDING SUFFICIENT SILT REMOVAL.
2. THE LEVEL OF SILT IN RUNOFF DURING CONSTRUCTION IS TO BE MONITORED VISUALLY AND EXCESSIVE SILT LEVELS IN ANY AREA TO BE TEMPORARILY MANAGED BY PLACING SILT FENCES AT THE PROBLEM AREAS.
3. TEXTILE OF SILT FENCE TO BE HY-TEX TERRASTOP OR SIMILAR APPROVED.
4. CARE REQUIRED WHEN PLACING & SECURING TEXTILE ADJACENT TO BANKS TO ENSURE ALL WATER IS FORCED TO PASS THROUGH SILT FENCE AND CANNOT BYPASS GEOTEXTILE.

LAYOUT DWG	N/A	T-LAYOUT NO.	N/A
------------	-----	--------------	-----

DRAWING NUMBER	04728-RES-DRN-DR-CE-004	REV	1
----------------	-------------------------	-----	---

SCALE - AS SHOWN @ A3

**ENVIRONMENTAL IMPACT
ASSESSMENT REPORT 2023**

THIS DRAWING IS THE PROPERTY OF RENEWABLE ENERGY SYSTEMS LTD. AND NO REPRODUCTION MAY BE MADE IN WHOLE OR IN PART WITHOUT PERMISSION